



ONTEC series



Electric system



Lens COR



Easy open



Suspension bracket Bracket 30°



Wymiary [mm]:
Dimensions

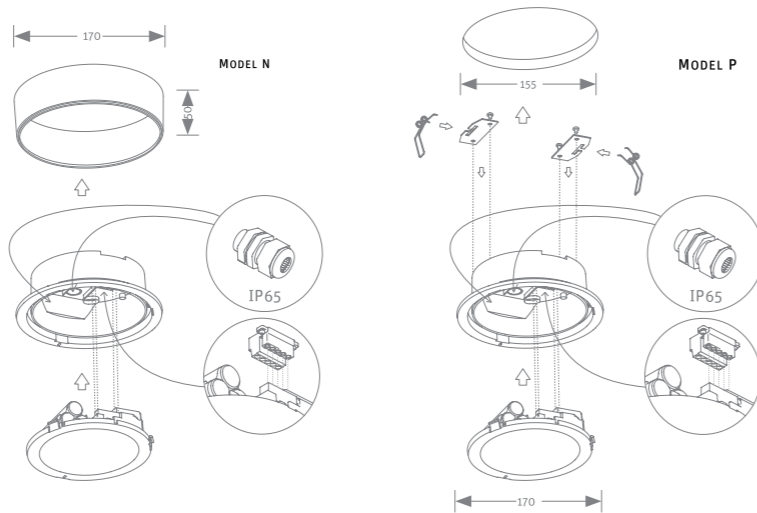

Typ Type	Model Model	Źródło światła Light source	Czas Time	Funkcja Function	Strumień Luminous flux	Dostępne kolory Available colours
-------------	----------------	--------------------------------	--------------	---------------------	---------------------------	--------------------------------------

WERSJA STANDARD (TEST RĘCZNY) / STANDARD VERSION (BUTTON TEST)

iTECH	1L/1/3W/N(P) ST	3W / 1×LED	1h	NM	- / 165 lm	W/S
iTECH	3L/1/3W/N(P) ST	3W / 1×LED	3h	NM	- / 165 lm	W/S
iTECH	1L/1/9W/N(P) ST	9W / 3×LED	1h	NM	- / 455 lm	W/S
iTECH	3L/1/9W/N(P) ST	9W / 3×LED	3h	NM	- / 395 lm	W/S
iTECH	1L/1/3W COR/N(P) ST	3W / 1×LED	1h	NM	- / 159 lm	W/S
iTECH	3L/1/3W COR/N(P) ST	3W / 1×LED	3h	NM	- / 159 lm	W/S
iTECH	1L/1/9W COR/N(P) ST	9W / 3×LED	1h	NM	- / 477 lm	W/S
iTECH	3L/1/9W COR/N(P) ST	9W / 3×LED	3h	NM	- / 395 lm	W/S

TEST AUTOMATYCZNY INDYWIDUALNY / AUTOMATIC SEPARATE TEST

iTECH	1L/1/3W/N(P) AT	3W / 1×LED	1h	NM	- / 165 lm	W/S
iTECH	3L/1/3W/N(P) AT	3W / 1×LED	3h	NM	- / 165 lm	W/S
iTECH	1L/1/9W/N(P) AT	9W / 3×LED	1h	NM	- / 455 lm	W/S
iTECH	3L/1/9W/N(P) AT	9W / 3×LED	3h	NM	- / 395 lm	W/S
iTECH	1L/1/3W COR/N(P) AT	3W / 1×LED	1h	NM	- / 159 lm	W/S
iTECH	3L/1/3W COR/N(P) AT	3W / 1×LED	3h	NM	- / 159 lm	W/S
iTECH	1L/1/9W COR/N(P) AT	9W / 3×LED	1h	NM	- / 477 lm	W/S
iTECH	3L/1/9W COR/N(P) AT	9W / 3×LED	3h	NM	- / 395 lm	W/S

CENTRALNY MONITORING / CENTRAL MONITORING

iTECH	1L/1/3W/N(P) DATA	3W / 1×LED	1h	NM	- / 165 lm	W/S
iTECH	3L/1/3W/N(P) DATA	3W / 1×LED	3h	NM	- / 165 lm	W/S
iTECH	1L/1/9W/N(P) DATA	9W / 3×LED	1h	NM	- / 455 lm	W/S
iTECH	3L/1/9W/N(P) DATA	9W / 3×LED	3h	NM	- / 395 lm	W/S
iTECH	1L/1/3W COR/N(P) DATA	3W / 1×LED	1h	NM	- / 159 lm	W/S
iTECH	3L/1/3W COR/N(P) DATA	3W / 1×LED	3h	NM	- / 159 lm	W/S
iTECH	1L/1/9W COR/N(P) DATA	9W / 3×LED	1h	NM	- / 477 lm	W/S
iTECH	3L/1/9W COR/N(P) DATA	9W / 3×LED	3h	NM	- / 395 lm	W/S

CENTRALNA BATERIA / CENTRAL BATTERY

iTECH	L/CB/3W/N(P)	3W / 1×LED	-	-	165 lm / 165 lm	W/S
iTECH	L/CB/9W/N(P)	9W / 3×LED	-	-	455 lm / 455 lm	W/S
iTECH	L/CB/3W COR/N(P)	3W / 1×LED	-	-	159 lm / 159 lm	W/S
iTECH	L/CB/9W COR/N(P)	9W / 3×LED	-	-	477 lm / 477 lm	W/S

COR – zawiera optykę do korytarzy / contains the optics for corridors
 NM – praca awaryjna / non maintained
 W – biały – kolor standardowy / white – standard colour

S – kolor na specjalne zamówienie / colour for special order
 N – wersja natynkowa / surface mounted
 P – wersja podtynkowa / recessed mounted

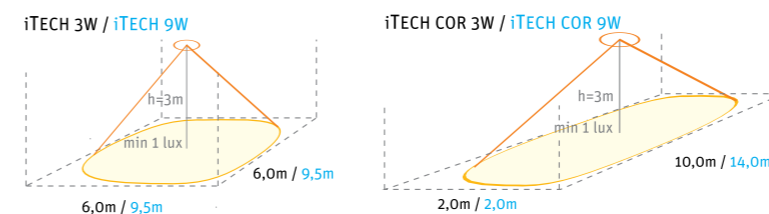

IP65

LED

3h

850°C



230VAC

